

# Threaded End Connection

## Series D Ductile Iron

- Top Entry Swing Check Valve
- To 2000 PSI WP
- 1" Through 4"
- Threaded Body Construction

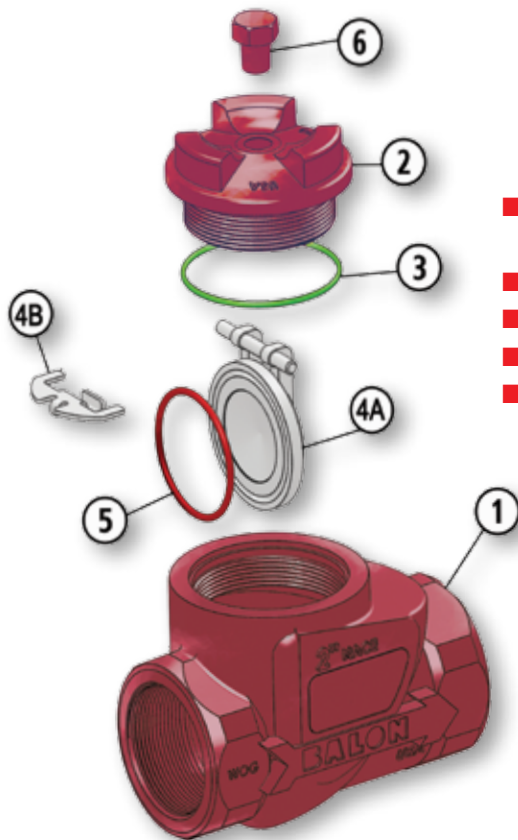

- High Grade Annealed Ductile Iron for Better Corrosion Resistance and Greater Yield Strength
- Patented Hinge-Works for Extended Life
- Stainless Steel Disc Standard
- Improved by Design for Easier Bonnet Removal
- NACE Standard

### Material Description

ITEM	PART NAME	DESCRIPTION
1	Body	ASTM A395 Class 60-40-18 Fully Annealed
2	Bonnet	ASTM A395 Class 60-40-18 Fully Annealed
3	Bonnet Seal	Fluorocarbon (Buna-N Optional)
4A	Disc	Replaceable 316 Stainless Steel
4B	Disc Hanger	Stainless Steel
5	Disc Seal	Fluorocarbon
6*	Pipe Plug	Carbon Steel

\* Not available in 1"

### Dimensional Data

SIZE	CATALOG	PORT	WP	A	B	C	LBS.
1	1F-D42-SE	1	1000	4.25	2.87	1.12	4
1	1F-D92-SE	1	2000	4.25	2.87	1.12	4
2	2F-D12-SE	2	300	6	3.75	1.81	10
2	2F-D32-SE	2	750	6	3.75	1.81	10
2	2F-D42-SE	2	1000	6	3.75	1.81	10
2	2F-D62-SE	2	1500	6	3.75	1.87	11
2	2F-D92-SE	2	2000	6	3.75	1.87	11
3	3F-D32-SE	3	750	8	4.45	2.43	21
4	4F-D32-SE	4	750	10	5.54	3.00	36

